



Termix Novi

Instantaneous water heater for flats, single-family houses and small apartment buildings with up to 4 flats.

Instantaneous water heater with heat exchanger and flow compensated temperature controller. Designed for wall-mounting.

Application

The Termix Novi is an instantaneous water heater featuring superb heat extraction and high performance. The Termix Novi is suitable for flats, single-family houses as well as for small apartment buildings. The water heater is available in two sizes, either for 1 apartment, or up to 4 apartments. The Termix Novi is applicable for decentralized heating systems – as well as for district heating networks with summer operation at low temperatures or with changes in differential pressure. The heat exchanger in Termix Novi cools the district heating water very efficiently, thereby creating a very good operation economy.

Domestic hot water (DHW)

The domestic hot water is prepared in the heat exchanger and the temperature is regulated by a flow-compensated temperature controller with an integrated differential pressure controller. The Danfoss IHPT valve ensures a stable hot water temperature by

varying differential pressure without the need for readjusting the valve. This protects the heat exchanger against overheating and lime scale formation. Furthermore the IHPT valve has an integrated idle temperature controller, which keeps the house supply line warm. This shortens the waiting periods during summer when the heating system is in reduced operation, which is ideal where high comfort is requested.

Options

The water heater can be supplied with a built-in non-return valve and safety valve mounted in the cold water supply. The water heater can also be supplied with a thermostatic circulation valve and a non-return and pressure equalizer (GTU).

Construction

All pipes are made of stainless steel. The connections are made by nuts and gaskets. The Termix Novi is delivered with an attractive grey full insulation in modern design, emphasising the high level of quality and comfort which characterises this product.

FEATURES AND BENEFITS

- Instantaneous water heater
- DHW regulation with an accelerated thermostatic control
- Capacity: up to 61 kW DHW
- DHW in sufficient quantity
- Operates independently of differential pressure and flow temperature
- Minimum space required for installation
- Pipes and plate heat exchanger made of stainless steel
- Minimized risk of lime scale and bacteria formation
- Optimum temperature regulation up to DH supply temperature 100 °C

Termix Novi

Circuit diagram example

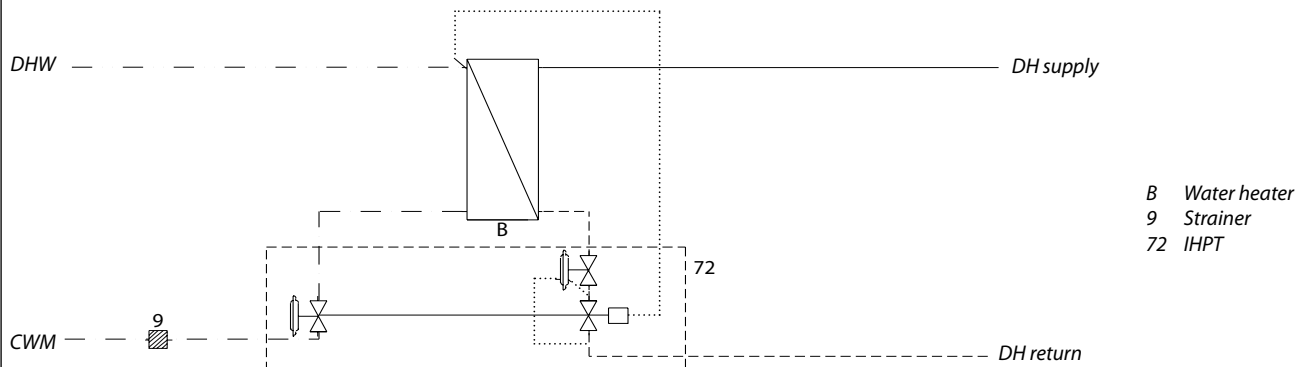

Technical parameters:

Nominal pressure: PN 16
 DH supply temperature: $T_{max} = 120\text{ }^{\circ}\text{C}$
 DCW static pressure: $p_{min} = 1,5\text{ bar}$
 Brazing material (HEX): Copper

Weight incl. cover: 7 - 9 kg (incl. packing)
Cover: Grey full-insulation

Dimensions (mm):

With insulation: H 432 x W 300 x D 155
 With cover: H 442 x W 315 x D 155

Connections:

- 1 Domestic cold water (DCW)
- 2 Domestic hot water (DHW)
- 3 District heating flow (DH)
- 4 District heating return (DH)

Connections sizes:

DH + DCW + DHW: G 3/4" (ext. thread)

Options:

- Booster pump (increases DH flow)
- Grey-lacquered steel cover
- Safety valve and non-return valve (10 bar)
- Safety valve with thermostatic circulation set
- Thermostatic circulation set
- Non-return and pressure equalizer (GTU)

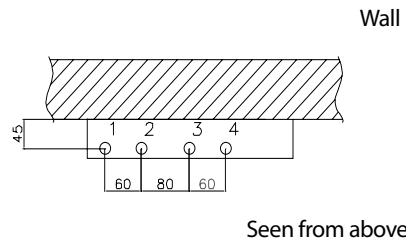

Seen from above

DHW: Capacity examples							DHW: Capacity examples						
Substation type	DHW Capacity kW	Supply flow Primary °C	Return flow Primary °C	DHW °C	Pressure loss Primary kPa	DHW Tap load l/h	Substation type	DHW Capacity kW	Supply flow Primary °C	Return flow Primary °C	DHW °C	Pressure loss Primary kPa	DHW Tapload l/h
Novi Type 1	32,3	60	19,8	10/45	20	798	Novi Type 2	32,3	55	21,9	10/45	22	798
	40,3	60	20,7	10/45	29	996		38	55	22,2	10/45	30	939
	43	70	17,4	10/45	20	1062		38	60	19,6	10/45	20	939
	53	70	18,5	10/45	29	1309		48,7	60	19,6	10/45	32	1203
	29	60	24,3	10/50	20	627		50	70	16,4	10/45	20	1235
	35	60	24,6	10/50	29	757		57	70	17,1	10/45	32	1400
	41	70	19,6	10/50	20	887		34	60	23,4	10/50	20	736
50	70	20,8	10/50	29	1082	44		60	24,1	10/50	32	952	
								48	70	18,8	10/50	20	1038
								61,5	70	19,4	10/50	32	1330

Gemina Termix A/S · Member of the Danfoss Group · Navervej 15-17 · DK-7451 Sunds · Denmark

Tel.: +45 9714 1444 · Fax: +45 9714 1159 · mail@termix.dk · www.heating.danfoss.com

Danfoss can accept no responsibility for possible errors in catalogues, brochures and other printed material. Danfoss reserves the right to alter its products without notice. This also applies to products already on order provided that such alterations can be made without consequential changes being necessary in specifications already agreed. All trademarks in this material are property of the respective companies. Danfoss and the Danfoss logotype are trademarks of Danfoss A/S. All rights reserved.